

Shoulder Bushings

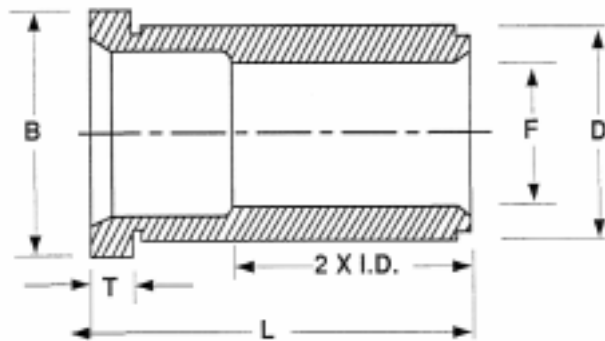

- Made from the finest quality alloy steel.
- Hardened and precision ground to reduce wear and provide longer life.

Tolerance Table				
Nominal Diameter	(F) Inner Dia.	(D) Outer Dia.	(B) Shoulder Dia.	(T) Shoulder Thickness
	+0.0005 -0.0000	+0.0005 -0.0000	+0.000 -0.010	+0.000 -0.005
1/2	.500	.750	.875	3/16
5/8	.625	.875	1.00	3/16
3/4	.7505	1.1255	1.250	3/16
7/8	.8755	1.2505	1.375	3/16
1	1.0005	1.3755	1.500	3/16
1-1/4	1.2505	1.6255	1.750	3/16
1-1/2	1.5005	2.0005	2.125	3/16
2	2.0005	2.5005	2.625	3/16
2-1/2	2.5005	3.2505	3.375	3/16
3	3.0005	3.7505	3.937	1/2

(L) Length	(F) 1/2"	Price	(F) 5/8"	Price	(F) 3/4"	Price	(F) 7/8"	Price	(F) 1"	Price
7/8	12078B	15.20	58078B	11.45	34078B	9.50	78078B	10.95	10078B	11.40
1-3/8	12138B	15.70	58138B	12.60	34138B	10.95	78138B	11.90	10138B	12.35
1-7/8	12178B	17.60	58178B	14.15	34178B	11.90	78178B	13.30	10178B	13.80
2-3/8	12238B	19.00	58238B	15.20	34238B	12.35	78238B	14.25	10238B	14.75
2-7/8	12278B	20.10	58278B	16.45	34278B	13.30	78278B	15.20	10278B	15.70
3-3/8	---	---	---	---	34338B	14.25	78338B	16.15	10338B	17.10
3-7/8	---	---	---	---	34378B	14.75	78378B	17.60	10378B	18.05
4-3/8	---	---	---	---	34438B	15.70	78438B	18.55	10438B	19.50
4-7/8	---	---	---	---	34478B	16.65	78478B	19.50	10478B	20.45
5-7/8	---	---	---	---	34578B	18.05	78578B	21.40	10578B	22.35

(L) Length	(F) 1-1/4"	Price	(F) 1-1/2"	Price	(F) 2"	Price	(F) 2-1/2"	Price	(F) 3"	Price
7/8	114078B	11.40	112078B	14.75	---	---	---	---	---	---
1-3/8	114138B	13.30	112138B	15.70	20138B	16.65	212138B	20.45	---	---
1-7/8	114178B	14.25	112178B	17.10	20178B	19.00	212178B	24.70	---	---
2-3/8	114238B	15.70	112238B	18.55	20238B	21.40	212238B	29.00	---	---
2-7/8	114278B	18.05	112278B	20.45	20278B	23.75	212278B	32.80	---	---
3-3/8	114338B	19.50	112338B	21.85	20338B	26.15	212338B	37.05	---	---
3-7/8	114378B	20.45	112378B	25.20	20378B	29.00	212378B	40.85	30378B	49.90
4-3/8	114438B	21.85	112438B	27.55	20438B	31.35	212438B	45.15	---	---
4-7/8	114478B	23.30	112478B	29.45	20478B	33.75	212478B	48.95	30478B	58.45
5-7/8	114578B	25.20	112578B	33.25	20578B	34.20	212578B	57.50	30578B	68.40
7-7/8	---	---	---	---	---	---	---	---	30778B	90.75