

# Metric Ejector Pins

- JIS Standard - Nitrided Surface •
- Constructed from premium hot work die steel •
  - Heat treated to ensure a tough core •
  - Smooth ground, friction free surface •
- Nitrided pin body for a surface hardness of 64-74 Rc •
- Pin head solid forged and annealed to prevent breakage •

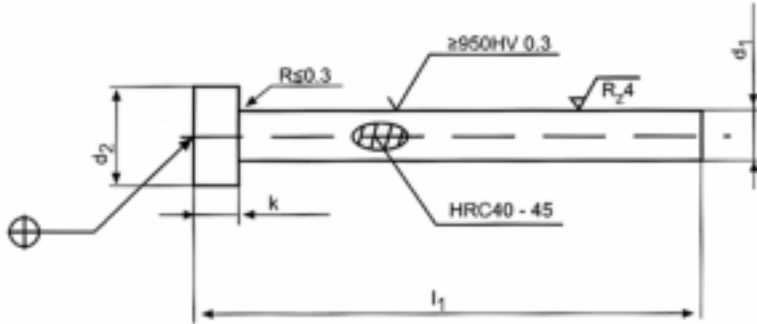

Tolerance Table			
(d <sub>1</sub> ) Pin Diameter	(d <sub>2</sub> ) Head Dia.	L <sub>1</sub> Length	(k) Head Thick
-0.01	0	+5	0
-0.02	-0.2	+0.1	-0.05
All dimensions are metric.			

(d <sub>1</sub> ) Pin Dia.	(d <sub>2</sub> ) Head Dia.	(k) Head Thick	L = 100MM	Price	L = 150MM	Price	L = 200MM	Price	L = 250MM	Price
1.0	6	4	B1x100JN	4.20	B1x150JN	5.90	B1x200JN	6.65	---	--
1.5			B1.5x100JN	2.45	B1.5x150JN	3.70	B1.5x200JN	6.10	B1.5x250JN	6.90
2			B2x100JN	2.00	B2x150JN	2.10	B2x200JN	2.25	B2x250JN	2.45
2.5			B2.5x100JN	1.90	B2.5x150JN	2.00	B2.5x200JN	2.10	B2.5x250JN	2.40
3			B3x100JN	1.90	B3x150JN	2.00	B3x200JN	2.10	B3x250JN	2.30
3.5	7		B3.5x100JN	1.70	B3.5x150JN	1.90	B3.5x200JN	2.10	B3.5x250JN	2.35
4	8	6	B4x100JN	2.00	B4x150JN	2.05	B4x200JN	2.10	B4x250JN	2.40
4.5	9		B4.5x100JN	2.10	B4.5x150JN	2.30	B4.5x200JN	2.50	B4.5x250JN	2.65
5			B5x100JN	2.15	B5x150JN	2.35	B5x200JN	2.45	B5x250JN	2.65
5.5	10		B5.5x100JN	2.25	B5.5x150JN	2.55	B5.5x200JN	2.75	B5.5x250JN	3.35
6			B6x100JN	2.30	B6x150JN	2.45	B6x200JN	3.25	B6x250JN	3.30
6.5	11		B6.5x100JN	2.40	B6.5x150JN	2.55	B6.5x200JN	3.40	B6.5x250JN	3.45
7			B7x100JN	3.00	B7x150JN	3.20	B7x200JN	3.75	B7x250JN	4.45
7.5	13		B7.5x100JN	3.10	B7.5x150JN	3.30	B7.5x200JN	3.85	B7.5x250JN	4.55
8			B8x100JN	4.30	B8x150JN	4.60	B8x200JN	5.10	B8x250JN	5.50
8.5	14		B8.5x100JN	4.50	B8.5x150JN	4.80	B8.5x200JN	5.30	B8.5x250JN	5.70
9		B9x100JN	4.70	B9x150JN	5.00	B9x200JN	5.50	B9x250JN	6.20	
10	15	8	B10x100JN	3.20	B10x150JN	3.80	B10x200JN	4.65	B10x250JN	5.75
12	17		B12x100JN	3.85	B12x150JN	4.45	B12x200JN	5.15	B12x250JN	6.35
14	19		B14x100JN	4.65	B14x150JN	5.95	B14x200JN	7.05	B14x250JN	8.95
16	21		B16x100JN	6.95	B16x150JN	8.25	B16x200JN	9.55	B16x250JN	10.85
20	25		B20x100JN	9.60	B20x150JN	10.95	B20x200JN	12.80	B20x250JN	15.10
25	30		B25x100JN	23.05	B25x150JN	24.85	B25x200JN	28.75	B25x250JN	33.75

# Metric Ejector Pins

- JIS Standard - Nitrided Surface •
- Constructed from premium hot work die steel •
  - Heat treated to ensure a tough core •
  - Smooth ground, friction free surface •
- Nitrided pin body for a surface hardness of 64-74 Rc •
- Pin head solid forged and annealed to prevent breakage •

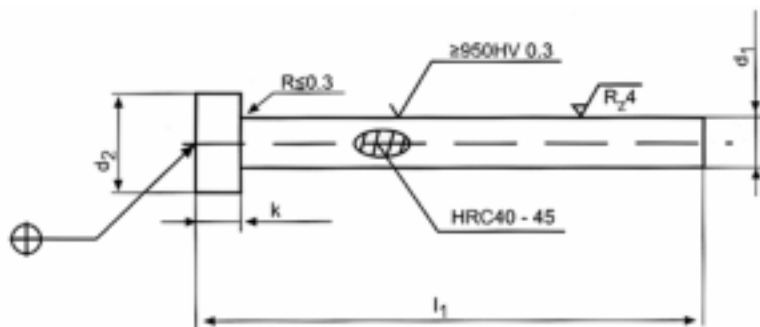

Tolerance Table			
( $d_1$ ) Pin Diameter	( $d_2$ ) Head Dia.	$L_1$ Length	(k) Head Thick
-0.01	0	+5	0
-0.02	-0.2	+0.1	-0.05

All dimensions are metric.

( $d_1$ ) Pin Dia.	( $d_2$ ) Head Dia.	(k) Head Thick	L = 300MM	Price	L = 350MM	Price	L = 400MM	Price	L = 450MM	Price	L = 500MM	Price	
1.0	6	4	---	--	---	--	---	--	---	--	---	--	
1.5			B1.5x300JN	7.10	---	--	---	--	---	--	---	--	
2			B2x300JN	3.30	B2x350JN	4.55	---	--	---	--	---	--	
2.5			B2.5x300JN	2.70	B2.5x350JN	3.50	B2.5x400JN	4.55	B2.5x450JN	5.20	B2.5x500JN	5.90	
3			B3x300JN	3.30	B3x350JN	4.55	B3x400JN	4.95	B3x450JN	5.50	B3x500JN	6.25	
3.5	7	B3.5x300JN	3.40	B3.5x350JN	4.65	B3.5x400JN	5.65	B3.5x450JN	6.25	B3.5x500JN	6.75		
4	8	6	B4x300JN	4.20	B4x350JN	4.75	B4x400JN	4.85	B4x450JN	4.95	B4x500JN	6.25	
4.5	9		B4.5x300JN	4.65	B4.5x350JN	4.75	B4.5x400JN	4.95	B4.5x450JN	5.50	B4.5x500JN	6.25	
5	10		B5x300JN	3.50	B5x350JN	4.10	B5x400JN	4.35	B5x450JN	5.80	B5x500JN	6.40	
5.5			B5.5x300JN	4.30	B5.5x350JN	4.55	B5.5x400JN	4.65	B5.5x450JN	5.90	B5.5x500JN	6.50	
6	11		B6x300JN	5.70	B6x350JN	5.95	B6x400JN	6.10	B6x450JN	6.75	B6x500JN	7.10	
6.5			B6.5x300JN	5.80	B6.5x350JN	6.10	B6.5x400JN	6.25	B6.5x450JN	6.75	B6.5x500JN	7.25	
7			B7x300JN	5.40	B7x350JN	5.75	B7x400JN	6.10	B7x450JN	6.80	B7x500JN	6.95	
7.5	13		8	B7.5x300JN	5.50	B7.5x350JN	5.90	B7.5x400JN	6.20	B7.5x450JN	6.90	B7.5x500JN	7.05
8	B8x300JN			6.10	B8x350JN	6.50	B8x400JN	6.65	B8x450JN	7.90	B8x500JN	8.10	
8.5	14			B8.5x300JN	6.30	B8.5x350JN	6.70	B8.5x400JN	6.95	B8.5x450JN	7.55	B8.5x500JN	8.40
9	B9x300JN	6.50		B9x350JN	6.90	B9x400JN	7.15	B9x450JN	7.75	B9x500JN	8.60		
10	15	B10x300JN		6.35	B10x350JN	7.90	B10x400JN	8.95	B10x450JN	9.50	B10x500JN	10.65	
12	17	B12x300JN		7.15	B12x350JN	8.15	B12x400JN	10.30	B12x450JN	11.75	B12x500JN	12.45	
14	19	B14x300JN		10.00	B14x350JN	12.75	B14x400JN	15.50	B14x450JN	18.45	B14x500JN	21.30	
16	21	B16x300JN		12.50	B16x350JN	14.40	B16x400JN	16.85	B16x450JN	22.35	B16x500JN	27.45	
20	25	B20x300JN		16.90	B20x350JN	20.05	B20x400JN	25.10	B20x450JN	34.80	B20x500JN	52.60	
25	30	B25x300JN		47.20	B25x350JN	55.25	B25x400JN	63.25	B25x450JN	73.40	B25x500JN	84.75	