

# Metric Ejector Pins

- European Standard DIN1530 - Through Hardened •
  - Constructed from Through Hardened Steel •
    - Smooth ground, friction free surface •
- Pin head solid forged and annealed to prevent breakage •
  - Hardness of 58-62 Rc Through Hardened •

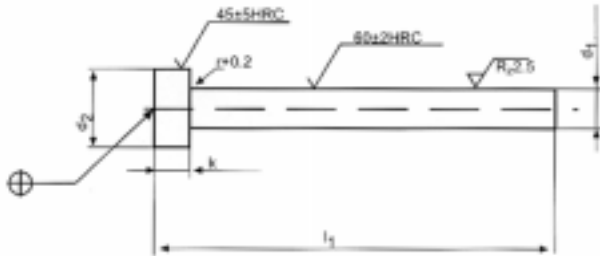

Tolerance Table			
(d <sub>1</sub> ) Pin Diameter	(d <sub>2</sub> ) Head Dia.	L <sub>1</sub> Length	(k) Head Thick
g6	0 -0.2	+2 0	0 -0.05
All dimensions are metric.			

(d <sub>1</sub> ) Pin Dia.	(d <sub>2</sub> ) Head Dia.	(k) Head Thick	(r)	L = 100MM	Price	L = 125MM	Price	L = 160MM	Price	L = 200MM	Price		
1.5	3	1.5	.2	B1.5x100E	3.90	B1.5x125E	4.15	B1.5x160E	4.30	B1.5x200E	4.80		
2.0	4	2		B2x100E	2.85	B2x125E	3.00	B2x160E	3.25	B2x200E	3.45		
2.2				B2.2x100E	2.85	B2.2x125E	3.00	B2.2x160E	3.25	B2.2x200E	3.45		
2.5	5			B2.5x100E	2.90	B2.5x125E	3.05	B2.5x160E	3.50	B2.5x200E	3.90		
3.0	6	3		.3	B3x100E	2.25	B3x125E	2.45	B3x160E	2.80	B3x200E	3.40	
3.2					B3.2x100E	2.85	B3.2x125E	3.00	B3.2x160E	3.15	B3.2x200E	3.75	
3.5	7				B3.5x100E	3.55	B3.5x125E	3.80	B3.5x160E	4.05	B3.5x200E	4.65	
3.7					B3.7x100E	3.60	B3.7x125E	3.80	B3.7x160E	4.05	B3.7x200E	4.50	
4.0	8				B4x100E	2.10	B4x125E	2.60	B4x160E	3.20	B4x200E	3.75	
4.2					B4.2x100E	2.75	B4.2x125E	2.90	B4.2x160E	2.95	B4.2x200E	4.05	
4.5			B4.5x100E		3.90	B4.5x125E	4.15	B4.5x160E	4.50	B4.5x200E	5.05		
5.0	10		B5x100E		1.90	B5x125E	2.10	B5x160E	2.50	B5x200E	2.80		
5.2			B5.2x100E		3.15	B5.2x125E	3.35	B5.2x160E	3.45	B5.2x200E	4.55		
5.5			B5.5x100E		3.90	B5.5x125E	4.10	B5.5x160E	4.80	B5.5x200E	5.80		
6.0	12	5	.5	B6x100E	3.25	B6x125E	3.45	B6x160E	3.95	B6x200E	4.40		
6.2				B6.2x100E	4.40	B6.2x125E	4.70	B6.2x160E	5.15	B6.2x200E	5.25		
6.5				B6.5x100E	4.65	B6.5x125E	4.90	B6.5x160E	5.25	B6.5x200E	6.55		
7.0				B7x100E	4.90	B7x125E	5.15	B7x160E	5.60	B7x200E	7.00		
8.0	14			B8x100E	4.05	B8x125E	4.25	B8x160E	5.05	B8x200E	5.90		
8.2				B8.2x100E	5.70	B8.2x125E	6.00	B8.2x160E	6.95	B8.2x200E	7.85		
8.5				B8.5x100E	5.50	B8.5x125E	5.80	B8.5x160E	7.00	B8.5x200E	8.15		
9.0				B9x100E	5.80	B9x125E	6.20	B9x160E	6.75	B9x200E	8.70		
10.0	16			B10x100E	4.70	B10x125E	4.95	B10x160E	5.75	B10x200E	7.05		
10.2				B10.2x100E	6.10	B10.2x125E	6.50	B10.2x160E	6.55	B10.2x200E	9.40		
10.5		B10.5x100E	7.30	B10.5x125E	7.75	B10.5x160E	8.15	B10.5x200E	10.20				
12.0	18	7	.8	B12x100E	5.85	B12x125E	6.20	B12x160E	6.80	B12x200E	7.75		
12.2				B12.2x100E	8.75	B12.2x125E	9.30	B12.2x160E	9.65	B12.2x200E	11.80		
12.5				B12.5x100E	7.40	B12.5x125E	7.90	B12.5x160E	8.05	B12.5x200E	9.95		
14.0	22			B14x100E	7.75	B14x125E	8.25	B14x160E	9.05	B14x200E	10.05		
16.0				B16x100E	10.40	B16x125E	10.30	B16x160E	16.65	B16x200E	13.70		
18.0	24			B18x100E	10.25	B18x125E	11.10	B18x160E	13.00	B18x200E	16.15		
20.0	26			8	1	B20x100E	11.20	B20x125E	12.20	B20x160E	14.95	B20x200E	12.10
25.0	32			10		B25x100E	26.40	B25x125E	27.30	B25x160E	30.30	B25x200E	31.45

# Metric Ejector Pins

- European Standard DIN1530 - Through Hardened •
  - Constructed from Through Hardened Steel •
    - Smooth ground, friction free surface •
- Pin head solid forged and annealed to prevent breakage •
  - Hardness of 58-62 Rc Through Hardened •

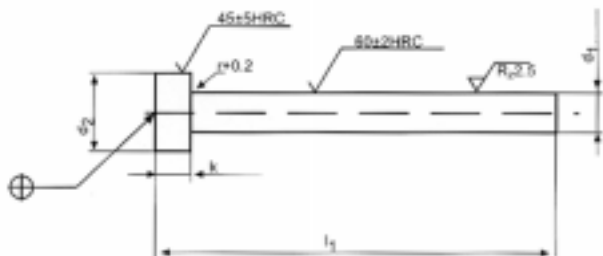

Tolerance Table			
(d <sub>1</sub> ) Pin Diameter	(d <sub>2</sub> ) Head Dia.	L <sub>1</sub> Length	(k) Head Thick
g6	0 -0.2	+2 0	0 -0.05
All dimensions are metric.			

(d <sub>1</sub> ) Pin Dia.	(d <sub>2</sub> ) Head Dia.	(k) Head Thick	(r)	L = 250MM	Price	L = 315MM	Price	L = 400MM	Price	L = 500MM	Price
1.5	3	1.5	.2	B1.5x250E	5.15	---	--	---	--	---	--
2.0	4	2		B2x250E	3.55	B2x315E	5.85	---	--	---	--
2.2			B2.2x250E	3.55	B2.2x315E	5.85	B2.2x400E	7.80	---	--	
2.5	5	3	.3	B2.5x250E	4.00	B2.5x315E	4.30	B2.5x400E	6.20	B2.5x500E	7.90
3.0	6			B3x250E	3.60	B3x315E	3.80	B3x400E	4.75	B3x500E	5.15
3.2				B3.2x250E	4.30	B3.2x315E	5.25	B3.2x400E	5.75	B3.2x500E	8.05
3.5	7			B3.5x250E	4.90	B3.5x315E	5.25	B3.5x400E	6.70	B3.5x500E	9.00
3.7				B3.7x250E	5.00	B3.7x315E	6.25	B3.7x400E	7.20	B3.7x500E	9.40
4.0	8			B4x250E	3.95	B4x315E	4.45	B4x400E	5.55	B4x500E	6.75
4.2				B4.2x250E	4.10	B4.2x315E	5.05	B4.2x400E	6.50	B4.2x500E	8.85
4.5				B4.5x250E	5.80	B4.5x315E	6.85	B4.5x400E	8.20	B4.5x500E	10.55
5.0	10			B5x250E	3.35	B5x315E	4.40	B5x400E	5.75	B5x500E	8.10
5.2				B5.2x250E	4.65	B5.2x315E	5.85	B5.2x400E	6.95	B5.2x500E	9.50
5.5		B5.5x250E	6.25	B5.5x315E	7.15	B5.5x400E	8.55	B5.5x500E	9.85		
6.0	12	5	.5	B6x250E	5.05	B6x315E	6.75	B6x400E	7.70	B6x500E	10.30
6.2				B6.2x250E	6.00	B6.2x315E	8.25	B6.2x400E	9.65	B6.2x500E	12.15
6.5				B6.5x250E	7.55	B6.5x315E	8.80	B6.5x400E	10.30	B6.5x500E	12.85
7.0				B7x250E	8.20	B7x315E	9.40	B7x400E	11.55	B7x500E	13.85
8.0				14	B8x250E	6.80	B8x315E	8.50	B8x400E	10.20	B8x500E
8.2	B8.2x250E	8.25	B8.2x315E		11.45	B8.2x400E	13.50	B8.2x500E	16.50		
8.5	B8.5x250E	10.00	B8.5x315E		11.35	B8.5x400E	14.15	B8.5x500E	17.25		
9.0	16	B9x250E	10.40	B9x315E	12.50	B9x400E	15.50	B9x500E	18.30		
10.0		B10x250E	8.15	B10x315E	9.90	B10x400E	12.00	B10x500E	16.70		
10.2		B10.2x250E	10.70	B10.2x315E	12.75	B10.2x400E	15.55	B10.2x500E	19.50		
10.5		B10.5x250E	13.30	B10.5x315E	15.50	B10.5x400E	18.45	B10.5x500E	23.45		
12.0	18	7	.8	B12x250E	9.00	B12x315E	12.40	B12x400E	17.35	B12x500E	20.35
12.2				B12.2x250E	13.85	B12.2x315E	18.20	B12.2x400E	22.00	B12.2x500E	27.05
12.5				B12.5x250E	12.15	B12.5x315E	16.10	B12.5x400E	19.40	B12.5x500E	26.70
14.0	22	1	B14x250E	11.65	B14x315E	16.05	B14x400E	19.10	B14x500E	27.15	
16.0			B16x250E	17.45	B16x315E	21.20	B16x400E	27.55	B16x500E	34.75	
18.0	24	8	B18x250E	17.65	B18x315E	23.65	B18x400E	25.80	B18x500E	53.75	
20.0	26		B20x250E	20.65	B20x315E	25.05	B20x400E	30.15	B20x500E	53.75	
25.0	32		B25x250E	38.40	B25x315E	62.95	B25x400E	71.70	B25x500E	96.70	