

# Date Stamps

## CUMSA SYSTEM

The CUMSA SYSTEM date stamps are the most molder friendly in the industry today. There is no need to remove the tool from the press to adjust or replace the insert. The date stamps listed on this page are for complete assemblies for Year, Month, Day, and Shift. Date stamp assemblies includes outer ring, inner arrow, and instructions. For component parts see next page.

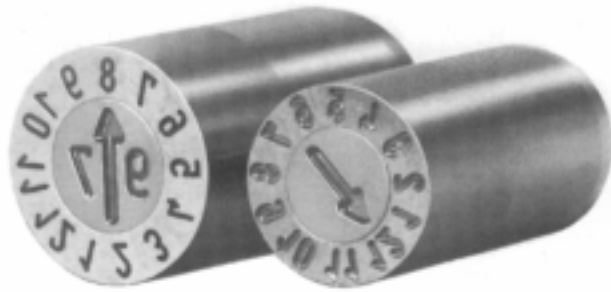

12 Months	Price	12 Mo. + Yr.	Price	Years	Price	31 Days	Price	Shifts	Price	A	C	D	E	L
DSM4	122.80	DSM4-__	122.80	DSY4	122.80	--	--	DSS4	128.00	4	2,2	6	3,5	12
DSM5	117.10	DSM5-__	117.10	DSY5	117.10	--	--	DSS5	128.00	5	3	6	3,5	12
DSM6	153.80	DSM6-__	154.30	DSY6	154.30	DSD6	169.70	DSS6	163.60	6	3,2	12	4	20
DSM8	155.40	DSM8-__	155.60	DSY8	155.80	DSD8	171.70	DSS8	165.10	8	4,7	12	6	20
DSM10	157.00	DSM10-__	158.60	DSY10	158.60	DSD10	175.00	DSS10	166.60	10	5,7	12	8	20
DSM12	160.00	DSM12-__	163.10	DSY12	163.10	DSD12	178.20	DSS12	169.60	12	6,7	12	10	20
DSM16	163.20	DSM16-__	166.30	DSY16	166.30	DSD16	182.40	DSS16	173.10	16	8,7	12	12	20
DSM20	171.50	DSM20-__	191.20	DSY20	191.20	DSD20	208.00	DSS20	208.00	20	10,7	12	14	20

When ordering, add the year required to the part number. Ex. DSM4-13.

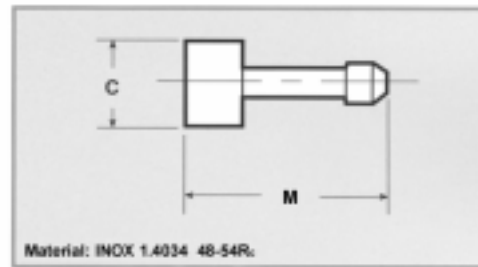
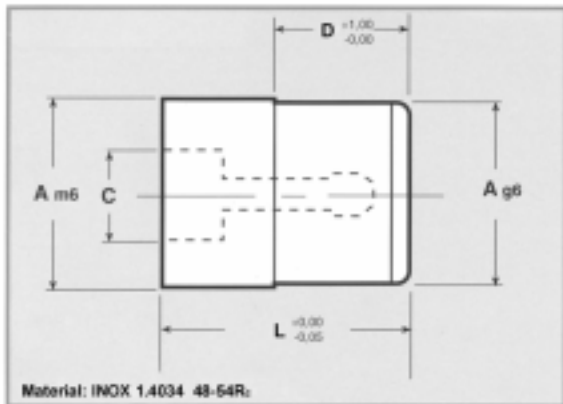

## Inserts



Arrow Only	Price	Arrow & Year	Price	C	M
DSIA22	34.00	DSI22-__	34.00	2,2	7,7
DSIA30	34.00	DSI30-__	34.00	3	7,7
DSIA32	38.50	DSI32-__	38.50	3,2	17
DSIA47	38.50	DSI47-__	38.50	4,7	17
DSIA57	38.50	DSI57-__	38.50	5,7	17
DSIA67	43.50	DSI67-__	43.50	6,7	17
DSIA87	43.50	DSI87-__	43.50	8,7	17
DSIA107	47.50	DSI107-__	47.50	10,7	17

When ordering, add the year required to the part number.  
Ex. DSI22-13.

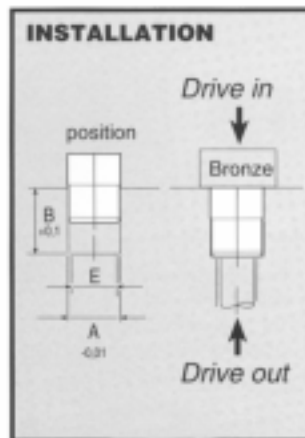
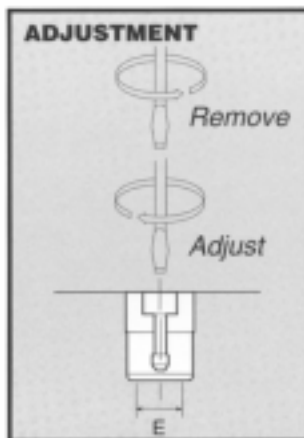

- **To Install:** Drill clearance hole 'E' to a maximum of 'A' - 2 mm through the plate. Machine 'A' dimension as shown for a press fit. Press date stamp into plate using a soft material such as bronze.
- **Adjustment:** To move insert arrow use screwdriver and turn arrow clockwise.
- **Removing Insert:** To remove insert, rotate counter-clockwise (the insert will start coming out only after several rotations). Install new insert by rotating until it "clicks" (this will happen only after the insert has reached the surface of the outer ring and been rotated several times).