

High Hardness Core Pins

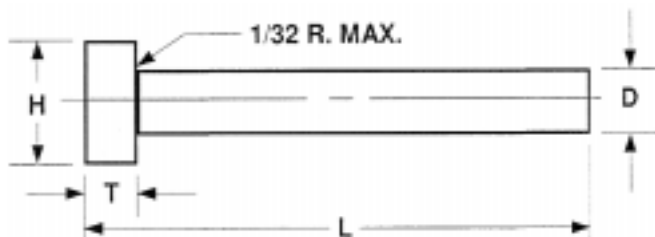

Tolerance Table			
(D) Pin Diameter	(H) Head Diameter	(T) Head Thickness	(L) Length
+0.001" -0.000"	+0.000" -0.010"	+0.000" -0.002"	+0.375" -0.000"

- Heat treated to a hardness of 50-55 Rc.
- Constructed from the finest hot work die steel.

- Precision ground after heat treating to meet or exceed industry standards.
- Heads are solid forged and annealed to prevent breakage.

(D) Pin Dia.	(H) Head Dia.	(T) Head Thick	Length 3"	Price	Length 6"	Price	Length 10"	Price	Length 14"	Price
3/64	1/4	1/8	CH046X3	5.95	CH046X6	6.70	---	---	---	---
1/16	1/4	1/8	CH062X3	5.70	CH062X6	6.30	---	---	---	---
5/64	1/4	1/8	CH078X3	5.20	CH078x6	5.75	---	---	---	---
3/32	1/4	1/8	CH093X3	4.30	CH093X6	4.40	CH093X10	5.25	---	---
7/64	1/4	1/8	CH109X3	4.60	CH109X6	4.70	CH109X10	5.45	---	---
1/8	1/4	1/8	CH125X3	2.80	CH125X6	2.85	CH125X10	3.75	CH125X14	4.65
9/64	1/4	1/8	CH140X3	2.90	CH140X6	3.00	CH140X10	3.70	CH140X14	4.40
5/32	9/32	5/32	CH156X3	2.85	CH156X6	2.95	CH156X10	3.75	CH156X14	4.55
11/64	11/32	3/16	CH171X3	2.95	CH171X6	3.05	CH171X10	3.90	CH171X14	4.75
3/16	3/8	3/16	CH187X3	2.95	CH187X6	3.05	CH187X10	3.90	CH187X14	4.75
13/64	3/8	3/16	CH203X3	2.95	CH203X6	3.05	CH203X10	4.00	CH203X14	4.70
7/32	13/32	3/16	CH218X3	3.05	CH218X6	3.15	CH218X10	4.00	CH218X14	4.85
15/64	13/32	3/16	CH234X3	4.20	CH234X6	4.90	CH234X10	9.30	---	---
1/4	7/16	3/16	CH250X3	3.35	CH250X6	3.55	CH250X10	4.40	CH250X14	4.95
17/64	7/16	1/4	CH265X3	4.70	CH265X6	5.35	CH265X10	11.25	---	---
9/32	7/16	1/4	CH281X3	3.75	CH281X6	3.80	CH281X10	4.75	CH281X14	5.55
19/64	1/2	1/4	CH296X3	5.05	CH296X6	5.75	CH296X10	10.95	---	---
5/16	1/2	1/4	CH312X3	4.00	CH312X6	4.10	CH312X10	5.35	CH312X14	6.70
21/64	9/16	1/4	CH328X3	5.35	CH328X6	6.20	CH328X10	11.75	---	---
11/32	9/16	1/4	CH343X3	4.30	CH343X6	4.40	CH343X10	6.00	CH343X14	7.60
23/64	5/8	1/4	CH359X3	5.70	CH359X6	6.50	CH359X10	12.00	---	---
3/8	5/8	1/4	CH375X3	4.75	CH375X6	4.85	CH375X10	6.50	CH375X14	8.15
13/32	11/16	1/4	CH406X3	5.15	CH406X6	5.35	CH406X10	6.95	CH406X14	8.55
7/16	11/16	1/4	CH437X3	5.70	CH437X6	5.90	CH437X10	7.60	CH437X14	9.30
15/32	3/4	1/4	CH468X3	6.20	CH468X6	6.30	CH468X10	8.40	CH468X14	10.50
1/2	3/4	1/4	CH500X3	6.65	CH500X6	6.75	CH500X10	9.15	CH500X14	11.55
9/16	13/16	1/4	CH562X3	7.50	CH562X6	7.80	CH562X10	10.55	CH562X14	13.30
5/8	7/8	1/4	CH625X3	8.95	CH625X6	9.20	CH625X10	12.45	CH625X14	15.70
3/4	1	1/4	CH750X3	12.25	CH750X6	12.55	CH750X10	17.05	CH750X14	19.60
7/8	1-1/8	1/4	---	---	CH875X6	19.15	CH875X10	25.45	CH875X14	27.50
1	1-1/4	1/4	---	---	CH1000X6	22.15	CH1000X10	29.10	CH1000X14	31.30