

Tolerance Table					
(D) Pin Dia.	(D ²) Press Fit Dia.	(P) Press Fit Length	(H) Head Dia.	(T) Head Thick	(L) Length
+0.0000" -0.0005"	+0.0005" -0.0000"	+0.00" -0.06"	+0.000" -0.010"	+0.000" -0.005"	+0.12" -0.00"

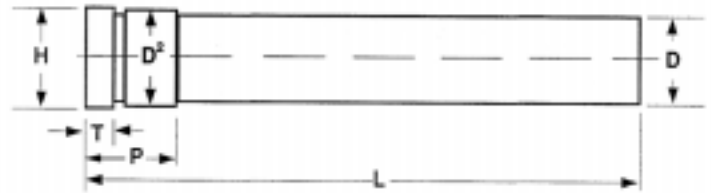

Nom. Dia.	(D) Pin Dia.	(D ²) P.F. Dia.	(H) Head Dia.	(T) Head Thick	(P) P.F. Length	(L) Length	Part Number	Price
3/8	.374	.376	.49	.25	.875	6"	AP37L06	7.75
1/2	.499	.501	.61	.25	.875	6"	AP50L06	9.60
5/8	.624	.626	.74	.25	.875	6"	AP62L06	12.15
3/8	.374	.376	.49	.25	1.375	10"	AP37L10	8.25
1/2	.499	.501	.61	.25	1.375	10"	AP50L10	13.35
5/8	.624	.626	.74	.25	1.375	10"	AP62L10	14.40
3/4	.749	.751	.86	.25	1.375	10"	AP75L10	17.95

- Constructed from high quality H-13 steel.
- Surface hardness of 65-80 Rc.
- Core hardness of 35-40 Rc.
- Surface finish of 4-5 micron.
- Heat treated, ground, nitrided, and polished surface.

Radiused Head Angle Pins

- Constructed from high quality H-13 steel.
- Surface hardness of 65-80 Rc.
- Core hardness of 35-40 Rc.
- Heat treated, ground, nitrided and polished surface.



Nom. Dia.	(D) Pin Dia.	(D ²) P.F. Dia.	(H) Head Dia.	(T) Head Thick	(P) P.F. Length	(L) Length	(R) SPH Rad	Part Number	Price
3/8	.3740	.3765	.500	.250	7/8	6"	.375	AP37L06R	8.10
1/2	.4990	.5015	.625	.250	7/8	6"	.500	AP50L06R	11.75
5/8	.6240	.6265	.750	.250	7/8	6"	.625	AP62L06R	12.75
3/8	.3740	.3765	.500	.250	1-3/8	10"	.375	AP37L10R	8.60
1/2	.4990	.5015	.625	.250	1-3/8	10"	.500	AP50L10R	14.00
5/8	.6240	.6265	.750	.250	1-3/8	10"	.625	AP62L10R	15.10
3/4	.7490	.7515	.875	.312	1-3/8	10"	.750	AP75L10R	18.95
1	.9990	1.0015	1.125	.312	1-3/8	10"	1.00	AP100L10R	29.40
3/4	.7490	.7515	.875	.312	1-3/8	14"	.750	AP75L14R	32.82
1	.9990	1.0015	1.125	.312	1-3/8	14"	1.00	AP100L14R	44.63